

PEDESTALS - Matt Woodgrain MFC

| SYLVAN CODE + COLOUR SUFFIX | | | |
|-----------------------------|------------------|--|--|
| M - MAPLE | NO - NATURAL OAK | | |
| W - WALNUT | B - BEECH | | |



600mm/800mm Desk High

Maple

Natural Oak

Walnut

Beech



**4 RANGES.
19 COLOURS.**

4 Woodgrain
Finishes

6 Gloss Finishes

6 MFC Finishes
by



3 High Definition
Laminated Finishes

Low Mobile - Under Desk

Maple

Natural Oak

Walnut

Beech



Lockable



Metal Drawer Runner



Sylvan Handle



Special Features

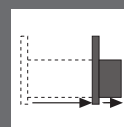

Metal
Drawer

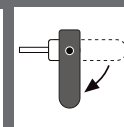

Hinged
Key

Our eco pedestals are tested and approved to BS4877-7:1998 test level 3 and achieved 40,000 cycles with a static load of 20kg without failure.



| | Stock Code | Assembled Size (mm) | Weight (Kg) | | | |
|--------------------|------------------------------|---------------------|-------------|-----|-------|----|
| | | | | | | |
| Silver Carcase | ECOP6 ECOP8 | 600/800 | | | | |
| | | 435 | 435 | 600 | 730 | 27 |
| | | 435 | 435 | 800 | 730 | 33 |
| Silver Carcase | ECOLMP2 | 567 | | | | |
| | | 435 | 435 | 572 | 562.5 | 21 |
| | | 435 | 435 | 572 | 562.5 | 21 |

*All products hold a manufacturer's warranty of 10 years. This guarantee covers all defects in materials & workmanship. Details on request. All products list NET prices including UK mainland delivery.

PEDESTALS - High Gloss MFC

REFLECTIONS CODE + COLOUR SUFFIX

DO - DARK OLIVE LO - LIGHT OLIVE BG - BURGUNDY
SG - STONE GREY WG - WHITE GLOSS BL - BLACK GLOSS



600mm/800mm Desk High

Stone Gloss



White Gloss



Dark Olive Gloss



Burgundy Gloss



Light Olive Gloss



Black Gloss



Low Mobile - Under Desk

Stone Gloss



White Gloss



Dark Olive Gloss



Burgundy Gloss



Light Olive Gloss



Black Gloss



**4 RANGES.
19 COLOURS.**

4 Woodgrain
Finishes

6 Gloss Finishes

6 MFC Finishes
by



**3 High Definition
Laminated Finishes**

Lockable



Metal Drawer Runner



Reflections Handle

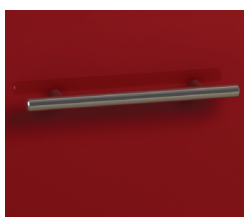

Special Features

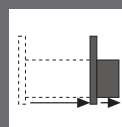

**Metal
Drawer**



**High Gloss Hinged
Key**

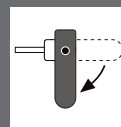

Our eco pedestals are tested and approved to BS4877-7:1998 test level 3 and achieved 40,000 cycles with a static load of 20kg without failure.



| | Stock Code | Assembled Size (mm) | Weight (Kg) | | | |
|-------------------|--------------------------------------|---------------------|-------------|-----|-------|------|
| | | | | | | |
| White Carcase | ECOPLUSP6 ECOPLUSP8 | 600/800 435 | W | D | H | (Kg) |
| | | | 435 | 600 | 730 | 27 |
| | | | 435 | 800 | 730 | 33 |
| White Carcase | ECOPLUSMP2 | 567 435 | W | D | H | (Kg) |
| | | | 435 | 572 | 562.5 | 21 |
| | | | | | | |

*All products hold a manufacturer's warranty of 10 years. This guarantee covers all defects in materials & workmanship. Details on request. All products list NET prices including UK mainland delivery.

PEDESTALS - Matt MFC

KALEIDOSCOPE CODE + COLOUR SUFFIX

LB - BLUE

GR - GREEN

OR - ORANGE

R - RED

Y - YELLOW

WH - WHITE



600mm/800mm Desk High

White

Blue

Green

Orange

Red

Yellow



Low Mobile - Under Desk

White

Blue

Green

Orange

Red

Yellow



**4 RANGES.
19 COLOURS.**

4 Woodgrain
Finishes

6 Gloss Finishes

6 MFC Finishes
by



3 High Definition
Laminated Finishes

Lockable

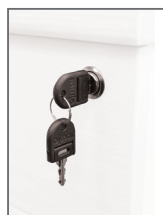

Metal Drawer Runner



Kaleidoscope Handle



Special Features

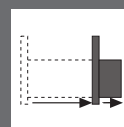

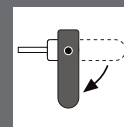

Metal
Drawer



Hinged
Key

Our eco pedestals are tested and approved to BS4877-7:1998 test level 3 and achieved 40,000 cycles with a static load of 20kg without failure.

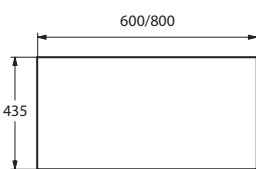

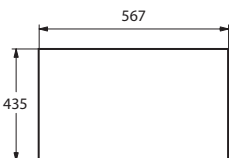
| | Stock Code | Assembled Size (mm) | Weight (Kg) | | | |
|---|------------------------|---|-------------|-----|-------|------|
| | | | | | | |
|  White Carcase | ECOPLUSP6 ECOPLUSP8 |  | W | D | H | (Kg) |
| | | | 435 | 600 | 730 | 27 |
| | | | 435 | 800 | 730 | 33 |
|  White Carcase | ECOPLUSLMP2 |  | W | D | H | (Kg) |
| | | | 435 | 572 | 562.5 | 21 |
| | | | | | | |

*All products hold a manufacturer's warranty of 10 years. This guarantee covers all defects in materials & workmanship. Details on request. All products list NET prices including UK mainland delivery.



600mm/800mm Desk High

Grey Anthracite



Blue Metallic



Frost White



HIGH DEFINITION
LAMINATED MDF
GLOSS FASCIAS



Low Mobile - Under Desk

Grey Anthracite



Blue Metallic



Frost White



Lockable



Metal Drawer Runner

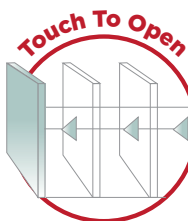

Special Features

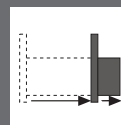

Metal
Drawer

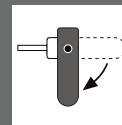

Hinged
Key

Our eco pedestals are tested and approved to BS4877-7:1998 test level 3 and achieved 40,000 cycles with a static load of 20kg without failure.

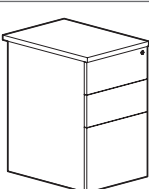
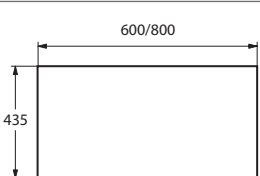

| | | | | | | | | | |
|--|----------------------------|---|---------------------|-----|-----|--------|--|--|--|
|  White Carcase | Stock Code |  | Assembled Size (mm) | | | Weight | | | |
| | HDECOPLUSP6 HDECOPLUSP8 | | W | D | H | (Kg) | | | |
| | | | 435 | 600 | 730 | 27 | | | |
| | | | 435 | 800 | 730 | 33 | | | |

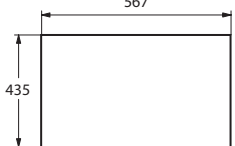
| | | | | | | | | | |
|--|---------------|---|---------------------|-----|-------|--------|--|--|--|
|  White Carcase | Stock Code |  | Assembled Size (mm) | | | Weight | | | |
| | HDECOPLUSLMP2 | | W | D | H | (Kg) | | | |
| | | | 435 | 572 | 562.5 | 25 | | | |

*All products hold a manufacturer's warranty of 10 years. This guarantee covers all defects in materials & workmanship. Details on request. All products list NET prices including UK mainland delivery.